

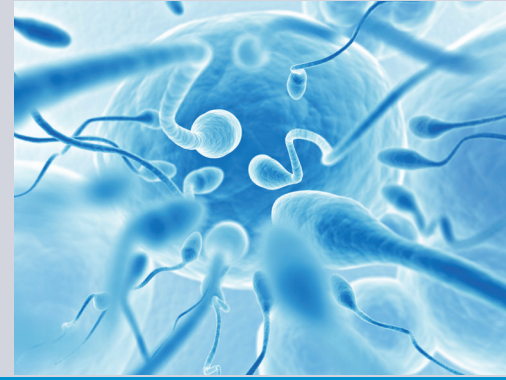

SDM 1 - Photometer for semen concentration analysis



Quick, accurate, easy

The SDM 1 is a compact, highly accurate photometer developed for measuring sperm concentrations. It can be calibrated for porcine, bovine, equine, canine and small ruminant species. Cleaning is simple, maintenance is minimal. The semen concentration is displayed in million sperm/ml.

Your benefits

- No dilution of semen samples necessary
- LED light source provides stable output, thereby reducing the frequent need for recalibration
- Cuvette is securely fixed in the correct measuring position
- User activates analysis once cuvette is in position
- Multiple readings of each sample are automatically performed and averaged to provide an accurate result
- Easy to clean and maintain: Simply lift the lid of the cuvette holder and wipe clean
- Calibration is performed automatically with each sample measurement
- Software updates are performed by interface connection

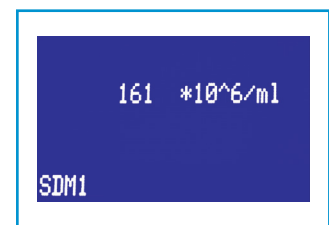
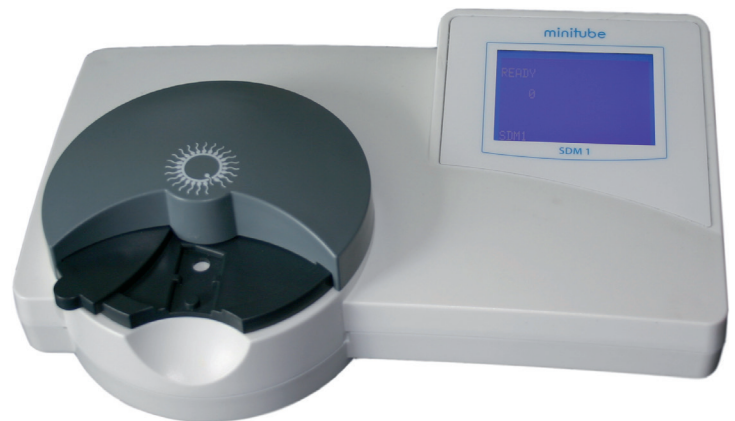

Result in million sperms/ml

Technical details

- Weight: 1.5 kg (net weight)
- Size: 25 x 13 x 5.5 cm (approx.)
- Display: LED
- Power supply: 110-240 V/50-60 Hz and battery

SDM 1 Porcine	REF.: 12300/0100
SDM 1 Equine	REF.: 12300/0101
SDM 1 Bovine	REF.: 12300/0102
SDM 1 Canine	REF.: 12300/0103
SDM 1 Caprine	REF.: 12300/0104
SDM 1 Ovine	REF.: 12300/0106

Multispecies software
for reprogramming to other species REF.: [12300/0130](#)

Microcuvette for SDM 1, 100/box REF.: [12300/1111](#)

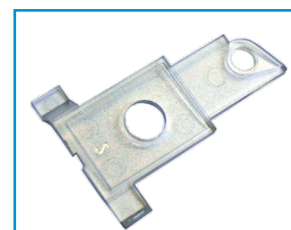

Microcuvette for secure fixation